

SK55 type DUCTILE IRON STEAM TRAP

CHARACTERISTICS

The SK55 is a float steam trap dedicated to the draining in medium pressure installations. With a ductile iron body, the SK55 steam trap has PN 16 flanges. In standard version, the SK55 is equipped with an internal strainer to protect the mechanism and with a sight glass to control the condensate flow. The standard version can be installed in a horizontal or vertical position and various inner mechanisms are available depending on the pressure differentials.



AVAILABLE ITEMS

PN16/25/40 flanged connections: DN 32, 40 and 50
 ΔP 4.5 / 10 / 14 bar

EC 97/23 DIRECTIVE CATEGORY

Category I

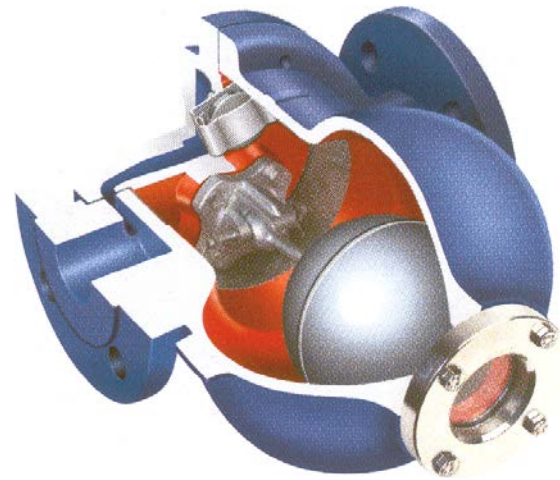

LIMITS OF USE

Max. allowable pressure (PS)	16 bar
Max. allowable temperature (TS)	250 °C
Max. pressure differentials	4.5, 10, 14 bar

CONSTRUCTION

#	Item	Material
1	Body	EN-GJS-400-18
2	Cover	EN-GJS-400-18
3	Thermostatic capsule	AISI 304
4	Thermostatic air vent	AISI 304
5	Float lever	AISI 304
6	Float	AISI 304
7	Filter	AISI 304

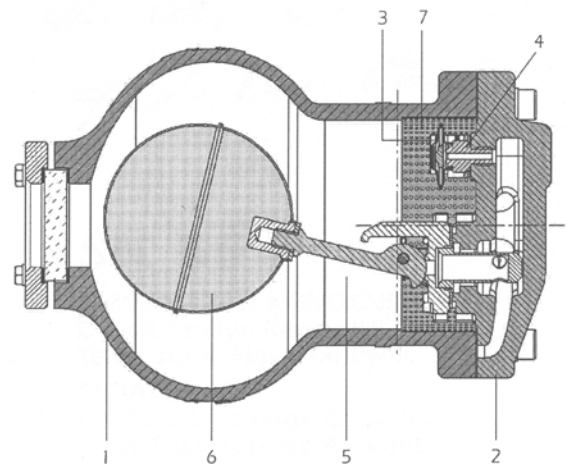

Technical data given for information purpose only. May be subject to alteration without prior notice

	SECTORIEL S.A. 45, rue du Ruisseau 38290 Saint Quentin-Fallavier – FRANCE Tel.: +33 474 94 90 70 – Fax: +33 474 94 13 95 www.sectoriel.fr / email: sectoriel@sectoriel.fr	Page	1/2
		Ref.	FT 1518 GB
		Rev.	1
		Date	03/2009

SK55 type DUCTILE IRON STEAM TRAP

FLOW RATES (kg/h)

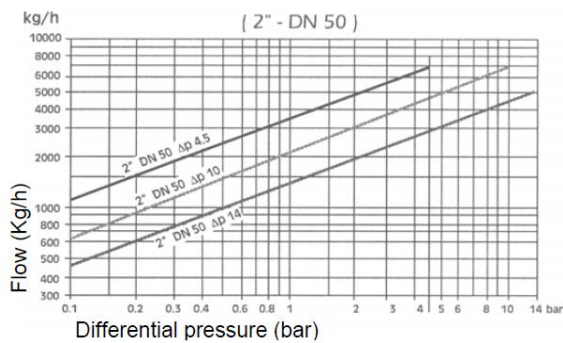
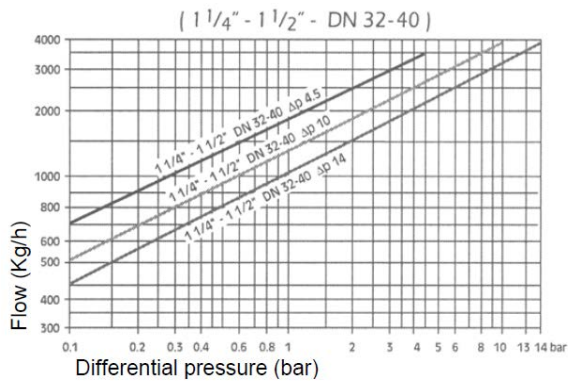

INSTRUCTIONS FOR INSTALLATION

The SK55 steam trap has to be installed lower than the pipework to drain. It is delivered for a horizontal mounting standard. Upstream from the steam trap, it is recommended to install a Y strainer in order to avoid damages caused by impurities on the steam trap seat. The steam trap outlet has to be connected to the condensate return system or directed to waste. In this case, please respect the maximum temperature allowance for the environment.

The SK steam trap mounting position is very important for its effective operation. 2 mounting instructions should be respected:

- 1/ The SK has to be installed in a horizontal position, following the direction of the arrow marked on the body: steam upstream and condensate downstream.
- 2/ The arrow marked on the nameplate has to point downwards.

Before installing the steam trap, isolate and depressurize the line. Please wait until the complete cooling of the system.

Carefully clean the upstream piping.

Fix the steam trap on the pipes after having checked the above mounting instructions.

For the flanged SK steam trap, please choose flange gaskets that are adapted to the use on steam. Use the below nut type:

Size	# of bolts	Diameter	Length
32, 40 and 50	4	M16	110

DISMANTLING AND MAINTENANCE

It is not necessary to remove the steam trap to proceed to its maintenance.

1. Shut the upstream isolating valve off.
2. Drain the downstream piping.
3. Please make sure that there is no pressure and no temperature.
4. Unscrew the 4 screws and remove cover (*mark 2 on the drawing, page 1*).
5. Check the float (*mark 6*) and the whole mechanism conditions. Clean and repair the damaged pieces if necessary.
6. Check the thermostatic air eliminator (*mark 3*) and the seat condition. Replace the air eliminator if necessary and clean the seat.
7. Remount the cover (*mark 2*) by changing the body gasket.

DIMENSIONS (mm) AND WEIGHT (kg)

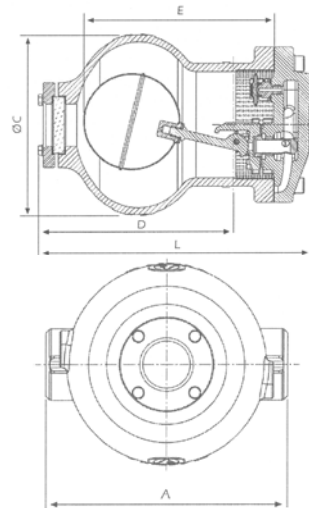

DN	A	ØC	D	E	L	# holes	W.
32	230	165	206	200	290	4	20.8
40	230	165	206	200	290	4	21.8
50	230	176	220	210	305	4	33.0

Technical data given for information purpose only. May be subject to alteration without prior notice

	SECTORIEL S.A.	Page	2/2
	45, rue du Ruisseau	Ref.	FT 1518 GB
	38290 Saint Quentin-Fallavier – FRANCE	Rev.	1
	Tel.: +33 474 94 90 70 – Fax: +33 474 94 13 95	Date	03/2009
	www.sectoriel.fr / email: sectoriel@sectoriel.fr		